



HYRISE ELEVATOR

Elevate Your Expectations

AN ISO 9001 : 2015 CERTIFIED CO.



**Lift Models Suitable for
Villas / Bungalows / Independent Floor**



ABOUT US

Welcome to HYRISE ELEVATOR, where we elevate the standards of vertical transportation.

OUR JOURNEY

Founded in 2019, HYRISE ELEVATOR has been at the forefront of the elevator industry in India. With a commitment to innovation and customer satisfaction, we have grown to become one of the leading providers of high-quality lift solutions.

OUR MISSION

Our mission is to provide safe, reliable, and efficient lift systems that enhance the flow of urban life. We strive to exceed expectations with our state-of-the-art technology and dedicated customer service.

OUR PRODUCTS

From residential buildings to towering commercial complexes, HYRISE ELEVATOR offers a wide range of products including:

- Passenger Lifts
- Freight Elevators
- Home Elevators
- Hospital Lifts

OUR COMMITMENT TO QUALITY

Quality is at the heart of everything we do. Our lifts are designed with precision and built to last, ensuring a seamless experience for all users. We adhere to the highest safety standards and are proud to be an ISO 9001 certified company.

OUR NETWORK

With a robust network of branches and service centers across India, we ensure prompt and efficient service delivery. Our team of skilled professionals is always ready to provide support and maintenance services.

WHY CHOOSE US?

Innovative Solutions: We constantly evolve our technology to meet the changing needs of our customers.

CUSTOMER FOCUS

Your satisfaction is our priority. We tailor our solutions to fit your unique requirements.

SAFETY FIRST

We never compromise on safety. Our lifts are equipped with the latest safety features to ensure peace of mind.

ECO-FRIENDLY

We are committed to sustainability. Our lifts are designed to be energy-efficient, reducing the environmental footprint.

Connect With Us

Discover how HYRISE ELEVATOR can transform your building's transportation system. Contact us for more information or to schedule a consultation.

Remember to personalize this template with your company's specific details and achievements. Highlight any awards, certifications, or notable projects that showcase your company's expertise and reliability in the lift industry.



RESIDENTIAL ELEVATOR

Hyrise Elevator bring convenience at your doorstep. They are luxurious, spacious and provide safety and reliability. Its soothing lighting, fixtures and varied hues would be in sync with your building's engineering. The ride will be cozy, comfortable and tension free like the lap of a mother. These will be children and senior citizen friendly, easy to enter, easy to operate and are the best options for residents as well as best customization for building organizers.

- **Speed** : 0.70 - 2.0 m/sec
- **Capacity** : 04-26 Passangers



HOSPITAL ELEVATOR

Generally hospital elevators requirement are laid down by the operating authorities of the hospital. Elevators will be required for patients, visitors, catering, housekeeping and other purpose, for this planning for a suitable dependable solution becomes a priority. Hyrise Elevator offers a unique combination of energy efficient solutions resulting in smooth ride, low waiting time, handicapped friendly and accommodating modern patient's beds and stretchers to give patients and visitors an assuring experience.

- **Speed** : 0.3 - 1.0 m/sec
- **Capacity** : 08-26 Passangers



AUTOMOBILES ELEVATOR

Automobile elevators are used in parking structures, apartment suites, auto dealership and even homes as well. With growing demand of parking space in the buildings and looking at the expensiveness of each length and breadth of the covered area, Hyrise Elevator offers best in class solution of with machine room gearless elevators, keeping everyone ecstatic from building organizers to end users. Hyrise elevator gives an answer for stopping issues in occupied urban advancements.

- **Speed** : 0.40 - 1.0 m/sec
- **Capacity** : upto 5000 Kg.



GOODS ELEVATOR

Hyrise holds the expertise of catering to the industrial elevators building needs, be it the high travel elevator requirement, structural shafts, non-standard hoist way dimensions and specialized in Ingress Protection (IP) which works under the extreme conditions of heavy dust, high pressure water and high/low temperatures. Over many decades Hyrise Elevator has demonstrated the commendable performance for industrial elevators working in power plants, factories, steel plants, cement plants, dams and other industrial category buildings.

- **Speed** : 0.3 - 0.6 m/sec
- **Capacity** : upto 10 ton



HOME ELEVATOR

A home elevator was once considered an extraordinary luxury, but today's homeowners and home builders have made elevators for home use more popular as more people place more value on convenience and the ability to age in place. A private home elevator is a specialized version of a commercial elevator, with the same basic principles of operation. Residential elevators should be built to meet certain code requirements that limit such things as the speed, size and capacity.

- **Speed** : 0.3 - 0.6 m/sec
- **Capacity** : 04-08 passanger



DUMBWAITER ELEVATOR

It's a small lift (most often waist-height) used to bring food up to a restaurant from kitchens below and to take dirty dishes back down from the dining room – a hidden and essential device in almost every mansion, café and restaurant. These hard wearing little service lifts are designed to carry goods, not people, between floors.

- **Speed** : 0.25 - 0.5 m/sec
- **Capacity** : upto 500 kg.



MACHINE ROOM ELEVATOR

An elevator machine room plays a crucial role in the efficient functioning of elevators. Despite being often overlooked, it serves as the control house for elevator operations. Here's what you need to know:

WHAT IS AN MACHINE ROOM ELEVATOR?

The elevator machine room is a specialized area that houses mechanical and electrical components necessary for smooth and secure elevator operation. Access to this room is restricted to authorized personnel due to the sensitive equipment it contains.

KEY COMPONENTS WITHIN THE MACHINE ROOM INCLUDE

ELEVATOR CONTROLLER

The controller acts as the brain of the elevator system. It monitors passenger calls, directs the elevator to the requested floor, and ensures safe operation. Elevator Motor: The motor is the drive unit responsible for lifting and lowering the elevator cabin. It's the powerhouse behind vertical movement. Disconnect Switches: The machine room houses two disconnect switches. One controls the unit's power supply, while the other manages the elevator's emergency lights. Emergency Brakes and Limit Switches: These critical components enhance passenger safety and prevent accidents.

MACHINE ROOM TYPES

Traction Elevator Machine Room:

Found in traditional elevator systems.

Contains the controller, motor, and other auxiliary components.

Requires a dedicated room within the building.

Hydraulic Elevator Machine Room:

Commonly used for low-rise buildings.

Houses the hydraulic pump unit, controller, and other essential elements.

Located near the elevator hoistway.

Machine-Room-Less Elevators (MRLs):

In modern architecture, where space optimization matters, machine-room-less elevators come to the rescue. Here's why they're gaining popularity:

SPACE EFFICIENCY

MRLs eliminate the need for a separate machine room. Instead, they accommodate machinery above the shaft or in adjacent spaces.

INTEGRATED DRIVE SYSTEM

MRLs lift resulting in energy savings. Compact Design: These elevators maximize usable floor space, making them ideal for tight spaces. Remember, whether you opt for a traditional machine room or an MRL, both play vital roles in ensuring safe and efficient vertical transportation. Elevators are more than just cabins; they're a blend of engineering marvels and convenience for passengers like you

CABIN OPTIONS

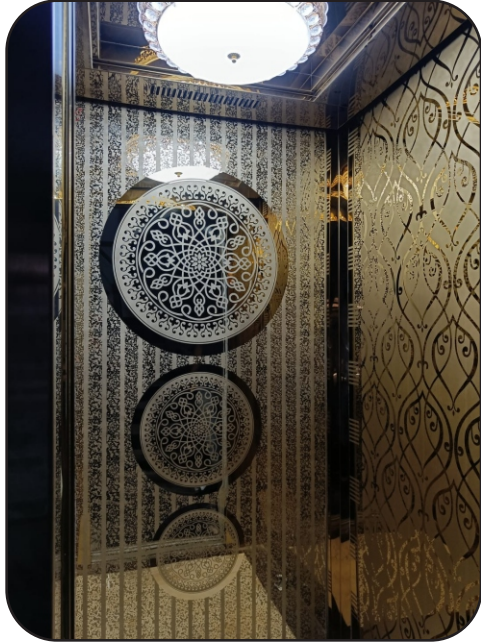

DOOR OPTIONS



MOTORS



AND DRIVES



OPEN LOOP CONTROLLER



CLOSE LOOP CONTROLLER





STANDARD SIZES								
(Standard ar Height - 2200mm)								
Rated Load (Kgs)	Rated Speed (mps)	Car Size (A) x (B), mm	Min. Hoistway Size (C) x (D), mm	Max. Hoistway Size (C) x (D), mm	Door Size (E) x (H), mm	Door Opening Type (ACO/ATO)	Pit Depth, mm	Overhead, mm
544 Kgs (8 P)	1.0/1.5	1050 x 1300	1750 x 1600	2000 x 1950	800 x 2000	ACO	1600 (1.0 MPS) / 2150 (FOR 1.5 MPS)	4800 (upto 1.5 MPS)
		1300 x 1100	1900 x 1400	2250 x 1750	800 x 2000	ACO		
		1000 x 1350	1600 x 1600	1950 x 1950	700 x 2000	ACO		
		1000 x 1350	1600 x 1600	1950 x 1950	700/800 x 2000	ATO		
		950 x 1400	1550 x 1700	1900 x 2050	800 x 2000	ATO		
680 Kgs (10 P)		1350 x 1300	2000 x 1800	2300 x 1900	800 x 2000	ATO		
		1350 x 1300	2000 x 1700	2300 x 1900		ACO		
		1200 x 1400	1900 x 1800	2150 x 2000		ACO		
		1150 x 1450	1800 x 1700	2100 x 2050	800 x 2000	ACO		
			1800 x 1800	2100 x 2150		ATO		
884 Kgs (13 P)		1200 x 1800	1950 x 2100	2150 x 2400	900 x 2000	ACO		
		1050 x 2100	1750 x 2350	2000 x 2700	800 x 2000			
		1050 x 2000	1950 X 2250	2000 x 2600	900 x 2000	ACO		
		1450 x 1450	2100 x 1750	2400 x 2100	900 x 2000	ACO		
		2000 x 1100	2650 x 1600	2950 x 1700	900 x 2000	ACO		
	1050 x 2000	1700 X 2350	2000 x 2600	900 x 2000	ATO			
1020 Kgs (15 P)	1050 x 2100	1700 x 2450	2000 x 2800	900 x 2000	ATO			
	1400 x 1750	2150 x 2050	2300 x 2350	1000 x 2000	ACO			
	1450 x 1650	2100 x 1950	2400 x 2250	900 x 2000	ACO			
	1500 x 1600	2150 x 1900	2450 x 2200	900 x 2000	ACO			
	1000 x 2400	1650 x 2700	1950 x 3050	900 x 2000	ATO			
	1200 x 2000	1950 x 2250	2100 x 2600	900 x 2000	ACO			
		1850 x 2300	2150 x 2650	1000 x 2000	ATO			
1088 Kgs (16 P)	1400 x 1800	2150 x 2100	2300 x 2400	1000 x 2000	ACO			
	2000 x 1300	2650 x 1700	2950 x 1900	1000 x 2000				
	1600 x 1600	2250 x 1900	2550 x 2100	1000 x 2000				
	1500 x 1700	2200 x 2000	2450 x 2350	1000 x 2000				
	1200 x 2100	1950 x 2350	2150 x 2700	900 x 2000	ATO			
		1850 x 2400	2150 x 2750	1000 x 2000				
1360 Kgs (20 P)	1600 x 1900	2500 x 2250	2650 x 2550	1000 x 2000	ACO			
	1700 x 1800	2600 x 2200	2750 x 2500		ATO			
	1250 x 2500	2100 x 2900	2300 x 3200					

Notes at bottom

1. If any requirement beyond the shaft sizes/car sizes mentioned above please contact us.
2. These shaft sizes have landing sill mechanism on door hence please contact us for clarification.
3. All dimensions are clear finished lift wells after plastering.
2. Hoistway front wall 230mm brick preferred.
3. Door Below lintel height to be min=clear entrance height +250mm.
4. RCC machine room slab 150 thick designed to sustain minimum 1000 kg/m2 UDL.
5. Front wall at the ground door to be made only after assembly of cabin.

ACO Automatic Centre Opening
ATO Automatic Telescopic Opening



MACHINE ROOM PLAN

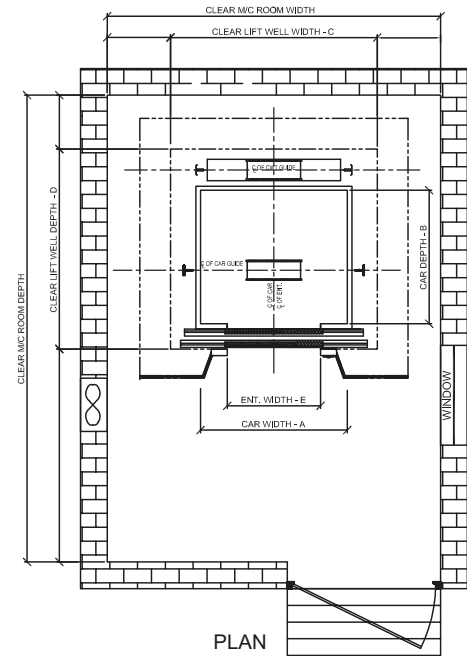
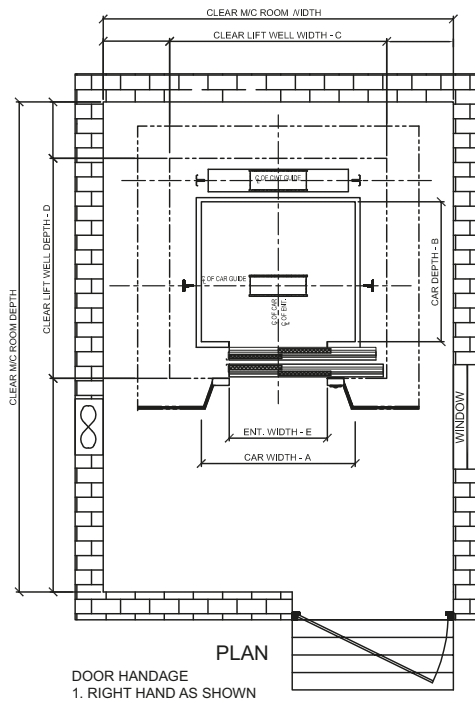
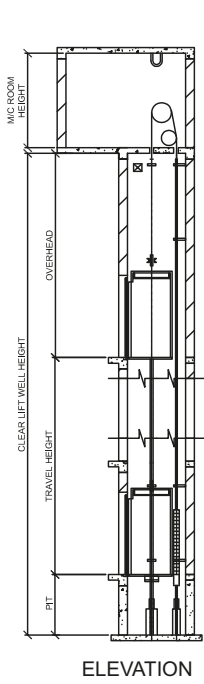

MACHINE ROOM LESS PLAN

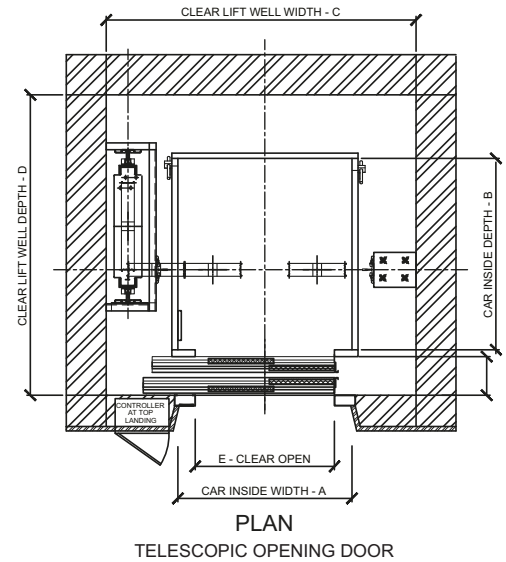
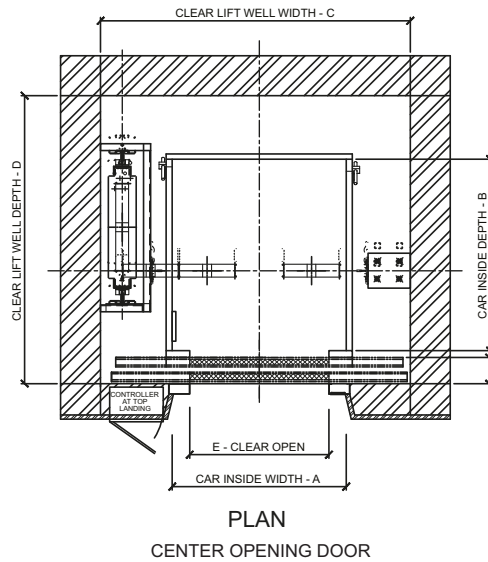
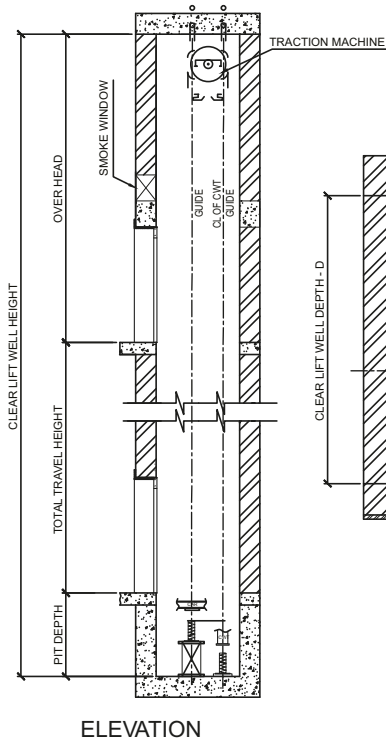



HYRISE ELEVATOR

Elevate Your Expectations

**Regd Office: Vishwas Nagar, Shahdara, Delhi-110032
M.: 9650219280, 8448110025**

**Branch Office (A) : UGF, Shop No. 2 & 3, Arina Complex, Saraswatipuram
Lane-1, Jail Bypass Road, Gorakhpur**

Branch Office (B) : 6/21/1, E-Block, Shastri Park Extension, Burari, Delhi-110084

www.hyriseelevator.com